



**AENON**<sup>TM</sup>  
SAFETY



***Global Manufacturer of Storage Solutions***

***Certified to most International Standards***

## Company Profile:

Aenon Safety LLC is a leading global manufacturer and partner, specializing in safety products and equipment. We collaborate with a wide network of manufacturers, facilitating the global distribution of top-tier safety gear. Our commitment to quality and safety excellence is at the core of our operations. We bridge the gap between manufacturers and distribution channels worldwide, ensuring that essential safety equipment reaches those who need it most. With a strong emphasis on innovation and customer satisfaction, we stand as a trusted name in the safety industry. Join us in our mission to make the world a safer place.

### Certifications



### Modernized Facilities





## INDUSTRIAL & LABORATORY



# RoHS

RFID intelligent reagent cabinet .....	2
Battery Recharging Cabinet .....	4
Outdoor Chemical Storage Container .....	5
Outdoor Chemical Storage Cabinet .....	8
30/60/90 minutes Safety Cabinet .....	9
Intelligent safety cabinet .....	10
Safety Storage Cabinet .....	12
Drum Storage Cabinet .....	14
Emergency equipment storage cabinet(PPE cabinet) .....	14
Combined safety storage cabinet .....	15
Narcotic Chemical Storage cabinet .....	16
Explosion proof gas cylinder cabinet .....	17
Gas cylinder storage cabinet .....	18
Gas cylinder storage cage .....	19
(LPG)Gas Cylinder Storage Cages .....	20
9 kg LPG Cylinder Storage .....	20
PP acid & corrosive storage cabinet .....	21
PP medicines cabinet / Reagent cabinet .....	22
PP fume hood .....	23
Countertop PE Spill Containment Tray .....	23
Steel Fume hood .....	24
PE IBC spill pallet .....	25
Polyethylene spill containment pallet .....	26
Steel Spill Containment Pallet .....	28
Mobile Sump Tray .....	28
Steel Spill Containment Pallet for IBC TANK .....	29
Oily waste can .....	30
Biochemical Trash Can .....	30
Portable Eyewash .....	31
Emergency Shower and Eye Wash Station .....	31
Anti-overflow emergency adsorbent kit .....	32

# RFID INTELLIGENT REAGENT CABINET

PROFESSIONAL SECURITY AND INTELLIGENT MANAGEMENT FOR HAZARDOUS CHEMICALS



## Product features

- Full life period management
- Visual management system
- Password login
- RFID/QR code/bar code recognition
- Wired/Wireless communication
- Intelligent alarm/fault alarm/
- Face recognition/finger recognition/IC card/account login
- Authorized management
- Locate Item
- Electronic Lock
- Remote update and maintaining
- Monitor state of door
- Power-off protection、 low-energy
- Management system/APP management software
- 10.1 inch capacitive touch screen
- Purchase-sales-inventory management
- Intelligent two-person management
- Intelligent weighing
- Upload and save the real-time data automatically
- Intelligent real-time monitoring management
- Intelligent and security management
- Intelligent storage condition management
- Fast connection to laboratory system
- Real-time monitoring running status
- Intelligent management of equipment operation and maintenance

**NEW**



H × W × D: 1183*378*580mm	
Loading capacity of weighing table:50KG	
System memory:256G	
Working temperature:10 -40	Working relative humidity :40%-85%
System configuration:Support local deployment/Multiple ports are suitable for various data docking	



## VISUAL SOLUTION FOR FULL LIFE PERIOD MANAGEMENT OF HAZARDOUS CHEMICALS



From the perspective of safety and convenience for users and high efficiency and intelligence for managers, a hazardous chemical management system is constructed. The whole process of the storage, use and management of hazardous chemicals is time-saving and labor-saving, with accurate data and clear responsibilities. A management system has been established for hazardous chemicals warehousing, label printing, application/approval for use, use/return, inventory counting, safety stock warning, first-in first-out, reagent scrap. Ensure that dangerous chemicals are used legally and in compliance. All operational behaviors and data can be visualized and traced to achieve the safety management of the whole life cycle of dangerous chemicals.

- Easy operation: RFID weighing system, automatically identify material information and associate users
- Process visualization : intelligent digital ledger, paperless recording of material in and out of storage, automated inventory counting
- Digitization and intelligent management: intelligent alarm, intelligent interaction, intelligent inspection
- Data security: Supports local deployment and seamless data docking

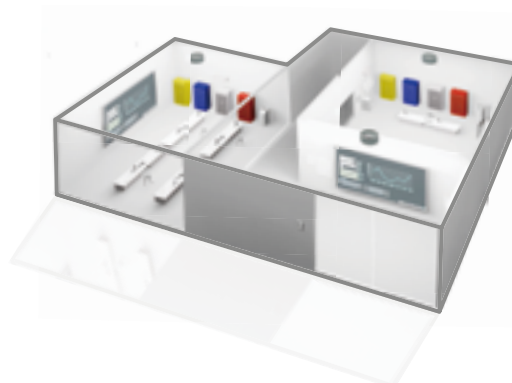

## ENVIRONMENT COLLECTION, MONITORING AND AUTOMATIC DISPOSAL OF ANOMALIES

- Intelligent cabinet has automatic inspection function of fan. It can 24h automatically collect temperature ,humidity and TVOC in the cabinet
- Once founding anomalies value,automatically adjusting to normal state
- If an abnormal value occurs for a long time, the alarm mechanism is associated immediately
- Hazardous chemicals are weighted by HJ-100 weighing console and put into the cabinet after weighing

Grey for toxic chemicals	Blue for corrosive liquid
Yellow for flammable liquids	Red for combustible liquids

Equipped with PP shelves and leakage-proof tray , which could prevented the risk of fall and leakage of chemicals



H × W × D	mm	Shelves	pcs	Loading capacity	kg	spill trays	pcs	Loading capacity	kg	Door type
1960×900×510			2		20		1		50	double door

## BATTERY RECHARGING CABINET

This product is used for storage and battery recharging of driller and other small sized electric power tools.

- The fire proof main structure is made of double layers of steel plate, there is recycled air ventilation inside the cabinet. The safety function is realized through automatic alarming system;
- Lead-free epoxy painting on both inside and outside surfaces with high temperature baking, which is anti-corrosion;
- LED lights are installed inside the cabinet, the whole no-glaring lighting system would be on when doors are open and provide average illumination;
- Each shelf is able to be adjusted freely, PP trays are set up at bottom of the cabinet, in order to collect the leaked corrosive liquid like electrolytes.

- 1.Humidity and temperature system
- 2.Sound and light alarming system
- 3.Fire proof recycled ventilation system
- 4.Leakage proof system
- 5.LED no-glaring lighting system

Electrical configuration:

Smoke detector, set fan, Micro dis-connectors, sets of LED lights, sound and light alarm, temperature & humidity controller, indicator(optional)



**ON/OFF PUSH BUTTON**

When batteries are placed and being recharged, all power sockets will be activated

**HUMIDITY AND TEMPERATURE CONTROL**

The temperature inside cabinet is able to be set up and connect to buzzer alarm

**LED LIGHTING SYSTEM**

Door-motion lighting control, the illumination is averagely diverted inside the cabinet

**GALVANIZED SHELVES**

All shelves are able to adjust freely and capable of heavy load

**TRANSPARENT INSPECTION WINDOWS ON THE DOORS**

Use the PMMA, tempered glass

**WIRING MANAGEMENT**

The cable running is safe and separated

H×W×D	mm	1800x1000x500	1800x1000x500	1800x1000x500
Adjustable shelves	Nos.	4	4	4
Load capacity of shelf	kg	30	30	30
layer structure		Single	Double	Double
Fan configuration		Fan is built inside / outside	Fan is built inside / outside	Fan is built inside / outside
Door type	With inspection windows Without inspection windows	- ZYBC01	ZYBC02 ZYBC03	- ZYBC04
Modle		Single layer steel structure	Double layer steel structure	Fire proof

# OUTDOOR CHEMICALS STORAGE CONTAINER



The full series products have CE certificate and Europe explosion-proof certificate(EN 60079). We provide professional solutions for the outdoor storage of hazardous chemicals.

Explosion-proof temperature control system, explosion-proof ventilation system, activated carbon purification system, inside fire protection system, inside environmental monitoring system, explosion-proof power distribution & control system, Intelligent management system, explosion-proof lighting system, pressure relief system, emergency spray system, access control system, anti-leakage system, Lightning protection system & Anti-static system.



## System introduction

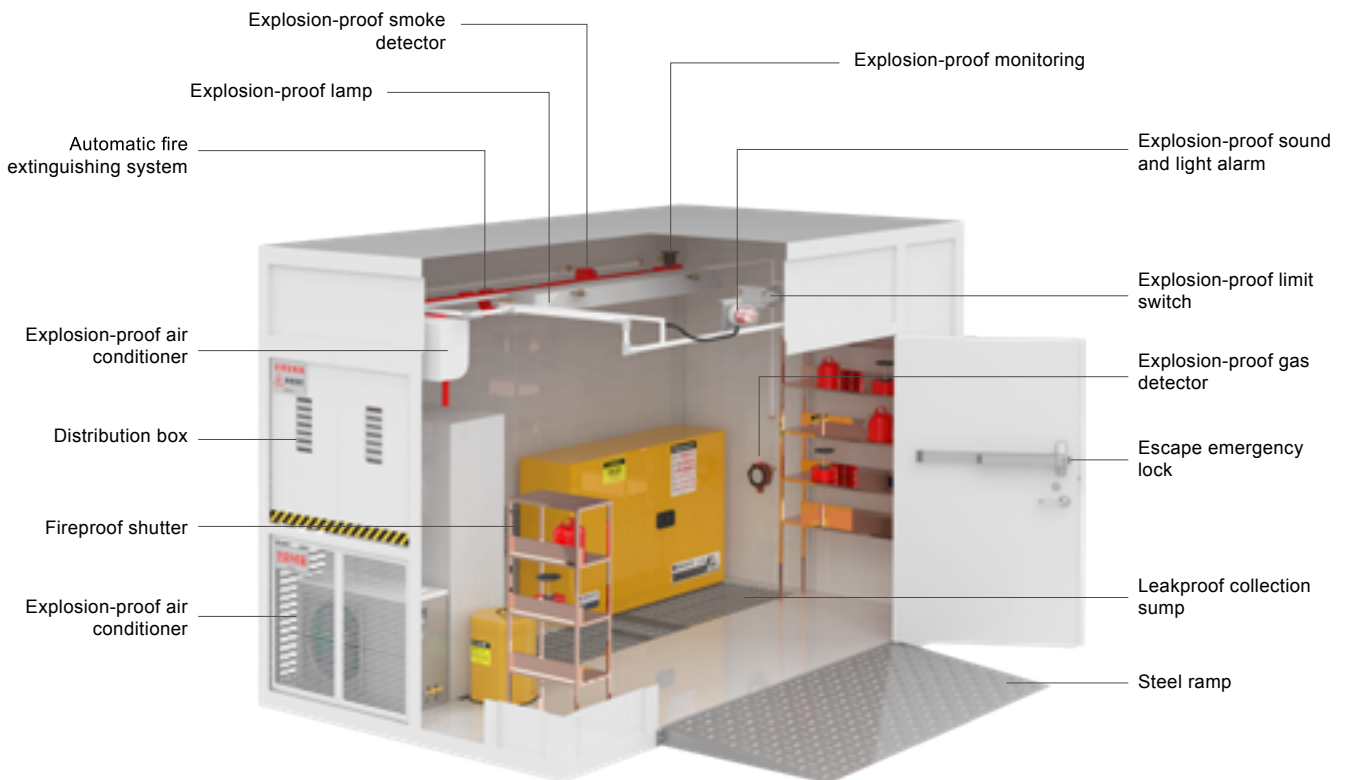



# SHELF TYPE HAZARDOUS CHEMICAL TEMPORARY STORAGE CONTAINER

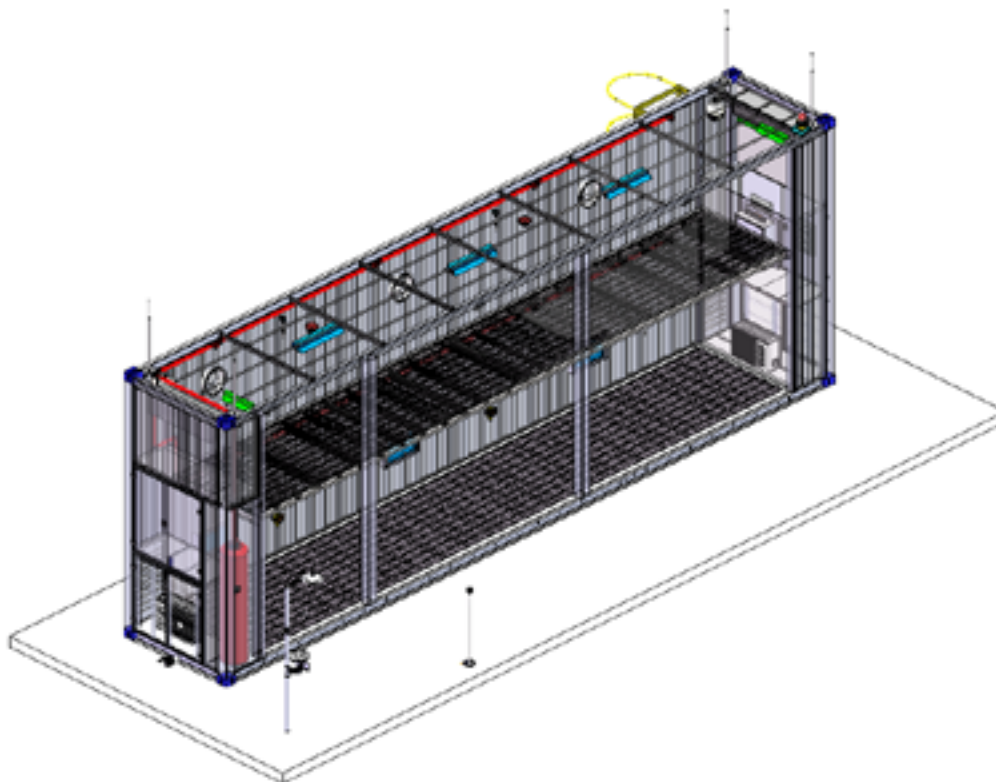

## Production feature

Suitable for storing drums and IBC large container;  
Apply in segregated storage of hazardous chemicals container, indoor or production workshop. Also use as outdoor central warehouse.



## Function introduction

- Store large quantity of chemicals
- Suitable for storage of drums and IBC
- Easy place on a horizontal foundation
- With lifting lugs, easy to loading and unloading
- Inside environment monitoring system
- Explosion-proof control system
- Automatic fire extinguishing system
- Explosion-proof vents system
- Anti-lightning & anti-static

# WALK-IN HAZARDOUS CHEMICAL TEMPORARY STORAGE CONTAINER

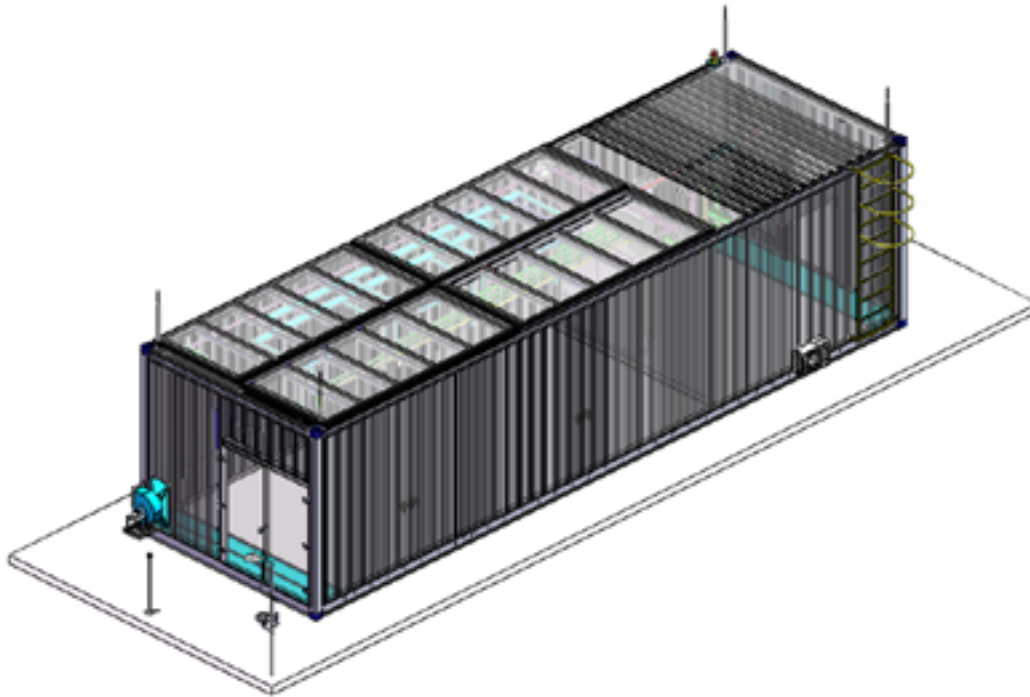

## Production feature

Suitable for storing drums and small container;  
Apply in segregated storage of hazardous chemicals container, indoor or production workshop. Also use as outdoor central warehouse.



## Function introduction

- With lifting lugs, easy to loading and unloading
- Stacking bucket can be placed for flexible use of the interior space
- Explosion-proof structure
- Temperature control system
- Automatic fire extinguishing system
- Purification system
- Explosion-proof ventilation system
- Anti-leakage device
- Steel ramp



## OUTDOOR CHEMICALS STORAGE CABINET

This product is for the purpose of safe storage proposal of flammable liquids and chemicals, which is capable to locate at outdoor areas.

Weathering proof structural design to withstand the outdoor application, fork channels at bottom for convenient transferring.

Multiple coatings of surface treatment, epoxy resin powder spray is effectively against the invasion of UV and rain water and provide better performance of corrosion resist.

Three point latching door lock with safe padlock, two-for-two lock management, which is complied with the <Safety Management Regulation of Hazardous Chemical>.

Vent devices are set up at left side and right side, this would help with the reduction of VOC density inside the cabinet and prevent fire accident.

The galvanized shelves are capable to adjust freely according to users' need, the adjust gap is 60mm, this would increase the application effect of space.

The spill sump is higher than 50mm, which would stop the spilling of leaked chemicals, considering the existence of corrosive liquids, there will be steel grids, which are corrosion-resist, impact-resist and heavy duty for loading.

Continuous piano hinge, which provides strong holding to doors and prevent them from sagging and increase the performance of explosion-proof. Static paint spray makes it corrosion-resist.

In order to guarantee the stability under bad weather, there are three pieces of stainless steel stiffeners underneath as reinforcement.

Strictly follow the OSHA regulation, the cabinet equips with conductor for grounding wires.



H × W × D	mm	1800x2100x1600
Capacity	Gal/Ltr	315/1220
Adjustable shelves	pieces	1
Load capacity of shelf	Kg	100
Door type		Double door/manual
Model		Yellow Red blue





### 30/60/90 MINUTES SAFETY CABINET

Safe storage of flammable, combustible and toxic substances in work area

- ☒ Made of special CFM fireproof material which passed fire proof test of 30, 60 and 90 minutes.
- ☒ Solid structure with high tensional strength, complies with GS standards.
- ☒ The hinged door can be locked at any release position, the door has an adjustable damping mechanism, which can be automatically closed when fire occurs.
- ☒ 3 partitions, the load capacity is 75kg (of average load), the height can be adjusted freely at a distance of 32mm. 1 tray at bottom made of powder coated-steel plate.



Style		Shelf type	Drawer type
Model		ZYC0060-9-1	ZYC0060-9-2
H×W ×D	mm	1950x890x614	1950x890x614
Shelf	pieces	3	3
Sump tray	pieces	1	1
Key lock configuration		3	3
Door type		double door/ automatic closing	double door/ automatic closing



## INTELLIGENT SAFETY CABINET

Professional storage solutions for various items which need strictly temperature control and highly security protection.

- The cabinet is made of high quality CRS with long working life and good fire resistance capacity.
- Double locking system (Digital lock+ Key lock) to enhance the management security.
- The cabinet inner is with white PP board and an adjustable air inlet at the side bottom.
- Stepped PP shelves with vent holes.
- Ventilation systems on top of the cabinet.

The intelligent safety cabinet is designed to effectively store and manage massive medicines and specimens. With good corrosive resistance capacity.

MODEL :ASYC0060E SERIES

The caster models are easy to move and much convenient in storing and taking chemicals in work sites to improve the work efficiency.

Widely used in schools, chemical industry, laboratory, scientific research institutions and other places.

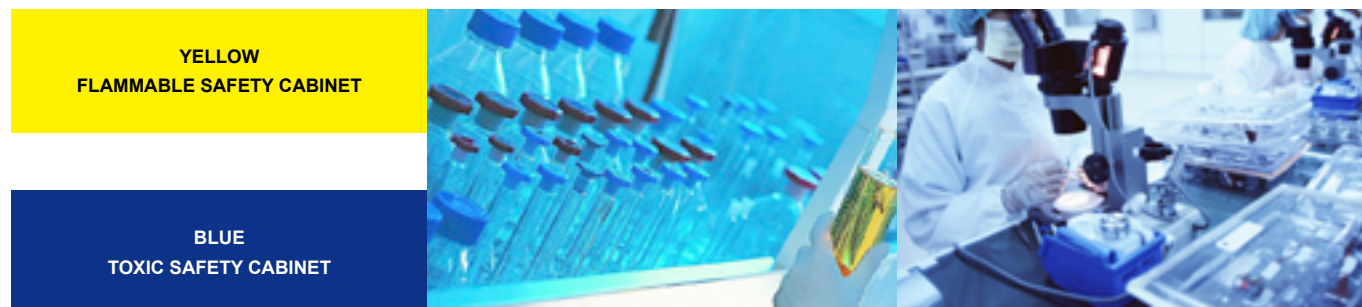

## Professional storage of all types of items that require both strict temperature control and a high degree of security

**Built-in fan/filter on the top of cabinet air outlet**

**Double-layer fireproof steel plate construction, surface epoxy resin electrostatic spraying, to prevent chemical erosion**

**Cabinet inner is with porcelain white PP(polypropylene) board, strong acid corrosion resistance**

**PP shelves with vent holes  
Strong acid resistance, easy to clean**

**The uninterrupted door hinge can be opened and closed easily, so that the door can be closed smoothly and prevent the door from hanging**

**The top is equipped with an LCD touch screen, Monitor the temperature and humidity in the cabinet in real time**

**Equipped with microcomputer time control switch, can automatically open and close the fan according to the setting**

**Professional standard warning labels in six languages to remind people to pay attention**

**Double locking system to enhance the management security, to prevent loss of accidents**

**An air intake is provided at the bottom for ventilation inside the cabinet**

MODEL	ASYC0060HK series	ASYC0090HK series	ASYC0060E series	ASYC0090E series	ASYC0060E purification series	ASYC0090E purification series	
H × W × D	mm	1810x860x860	1810x1090x860	1840x900x510	1960x900x510	1840x900x510	1960x900x510
Capacity	Gal/Ltr	60/227	90/340	-	-	-	-
Shelves	pcs	3	3	3	3	3	3
Loading capacity	kg	50	50	50	50	50	50
Door type		double door	double door	double door	double door	double door	double door
Model	yellow	ZYC0060KY	ZYC0090KY	ZYC0060EY	ZYC0090EY	-	-
Model	blue	ZYC0060KB	ZYC0090KB	ZYC0060EB	ZYC0090EB	-	-
Model		operation panel of temperature & humidity controller	operation panel of temperature & humidity controller	touch screen	touch screen	touch screen	touch screen



## FLAMMABLE LIQUIDS AND CHEMICALS SAFETY STORAGE

Safety storage flammable, combustion and weak corrosive liquids, comply with relevant regulatory requirements



### SAFETY STORAGE CABINET

Aenon Safety storage cabinets offer market high performance protection and code-compliant storage for flammable, corrosive, toxic, pesticides and other chemical liquids

OSHA CFR29 1910.106 & NFPA Code 30 Compliance

Capacity Gal/Ltr	H x W x D mm	Adjustable Shelves pcs	Shelves capacity kg	Door type	Model Yellow	Model red	Model Blue
4/15	560x430x430	1	50	single door	ASYC0004	ASYC0004R	ASYC0004B
12/45	890x590x460	1	50	single door	ASYC0012	ASYC0012R	ASYC0012B
13/45	460x1090x460	-	-	double door	ASYC0013	ASYC0013R	ASYC0013B
23/87	890x860x490	1	50	double door	ASYC0023	ASYC0023R	ASYC0023B
22/83	1650x590x460	2	50	single door	ASYC0022	ASYC0022R	ASYC0022B
30/114	1120x1090x460	1	100	double door	ASYC0030	ASYC0030R	ASYC0030B
45/170	1650x1090x460	2	100	double door	ASYC0045	ASYC0045R	ASYC0045B
60/227	1650x860x860	2	100	double door	ASYC0060	ASYC0060R	ASYC0060B
90/340	1650x1090x860	2	100	double door	ASYC0090	ASYC0090R	ASYC0090B
110/410	1650x1500x860	2	100	double door	ASYC0110	ASYC0110R	ASYC0110B



Fully welded, not riveted, construction holds squareness for longer life and offers greater protection in a fire since air gaps are reduced.

Sturdy 18-gauge (1-mm) double wall steel construction with 1-1/2-in (38-mm) of insulating air space.

Dual vents with built-in flash arresters strategically placed at bottom and opposite top.

Continuous piano hinge provides better open-close smooth operation, ensuring endurance and reliability.



2-in (51-mm) leakproof containment sump holds leaks and meets US EPA requirements.

Durable and chemical-resistant, lead-free powder-coat paint finish, inside and out, retains high gloss look and minimizes the effects of corrosion and humidity.



## HOW TO SELECT A SAFETY CABINET

### Size and type of container:

Determine if you are storing safety cans, 30- and 55-gallon (110- and 200-L) drums, smaller paint cans, 1 quart (4-L) bottles, aerosols, dispenser cans or other containers.

### Capacity:

Select specialty cabinets for on-the-spot needs; larger cabinets for expanded or large quantity storage.

### Type of chemical:

Easily identify, organize and segregate liquids by using the correct color cabinets.

Hazard classification for flammable liquids			
Class	Flash point	Boiling point	Examples
I-A	below 73°F (23°C)	below 100°F (38°C)	diethyl ether, pentane, ligroin, petroleum ether
I-B	below 73°F (23°C)	at or above 100°F (38°C)	acetone, benzene, cyclohexane, ethanol
I-C	73-100°F (24-38°C)	----	p-xylene
Hazard classification for combustible liquids			
II	101-140°F (39-60°C)	----	diesel fuel, motor oil, kerosene, cleaning solvents
III-A	141-199°F (61-93°C)	----	paints (oil base), linseed oil, mineral oil
III-B	200°F (93°C) or above	----	paints (oil base), neatsfoot oil

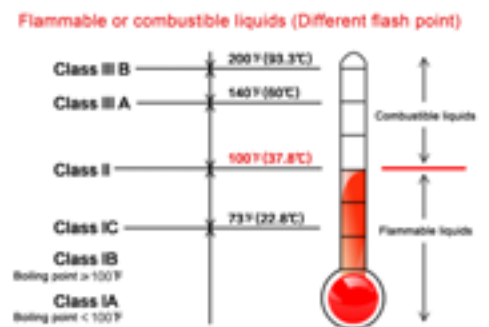

## Type of Safety Storage Cabinets

			<b>Yellow for flammable liquids</b>
			<b>Red for combustible liquids</b>
			<b>Blue for corrosive liquid</b>

For hazardous chemicals storage, colors and labels are generally used for identify different chemicals, so if fires occur, it is easy for firemen to identify hazardous chemicals.

## DRUM STORAGE CABINET

- For vertical 200L drums
- Can be equipped with roller drum base and drum cart.



Model		ASYC0060D	ASYC0110D-1	ASYC0110D-2
H × W × D	mm	1650x860x860	1650x1500x860	1650x1500x860
Type		single drum	double drum	combination
Nos. of 200L drum		1	2	1
Shelves capacity	kg	50	50	-
Door type		double door	double door	double door
Art.No.	Yellow	202340	202341	202342

## EMERGENCY EQUIPMENT STORAGE CABINET(PPE CABINET)

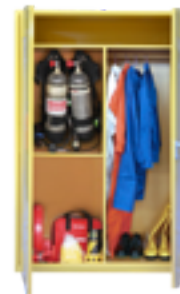

- The cabinet is made of high quality CRS plates, durable lead-free epoxy powder-coat finish provides excellent chemical resistance capacity.
- Standard double doors, designed with long visible windows, easy to identify equipments and utensils contained in the cabinets.
- With adjustable shelves to store different sized objects.
- T-shape compartment, suitable for storage of protective suits.

MODLE		ASYEP01	ASYEP02
H × W × D	mm	1200x900x500	1920x900x500
Door type		double door	double door
Art.No.		201600	201601



## COMBINED SAFETY STORAGE CABINET

Store all kinds of chemicals at the same time, partition placement, convenient management

Combined safety storage cabinet is suitable for flammable, toxic, corrosive chemicals and combustible chemicals, which is fire resistance, explosion-proof.

The cabinet is made of cold-rolled steel by folding welding structure of the whole forming, the surface of the cabinet without weld, 38mm between the two layers of steel forming a good fire insulation layer

It has good fire and explosion proof performance. The interior is PP (polypropylene) sheet, with strong acid and corrosion resistance.

Surface epoxy resin powder electrostatic spraying treatment, increase the ability to resist chemicals to prevent chemical erosion.

The ventilation holes on both sides of the cabinet can effectively reduce the concentration of volatile substances and prevent fire.

Equipped with three-point linkage lock to reduce friction or mechanical sparks, piano hinge makes the door closed smoothly.

The cabinet is equipped with an earthing device to lead electrostatic charge into the ground to reduce the risk of fire caused by electrostatic sparks.

The bottom is equipped with four moving wheels which can be manually adjusted screw, convenient for the positioning and overall movement of the hazardous chemical storage cabinet.



Each independent space is equipped with PP corrosion resistance leaky liquid tank, can effectively prevent the spill of chemical reagents



Door color are complied with GB2893-2008S standard

H × W × D	mm	1850x900x520	1840x590x460
Loading capacity	kg	50	50
Door type		4 spaces / single door , manual	4 spaces / single door , manual
Moving method		Adjustable casters	Adjustable casters
Art.No.		202311	202312



## NARCOTIC CHEMICAL STORAGE CABINET

Comply with OSHA 29 CFR 1910.106 and NFPA CODE30

- The cabinet is made of high quality CRS plates, durable lead-free epoxy powder-coat finish provides excellent chemical resistance capacity.
- Double locking system (Digital lock+ Key lock) to enhance the management security.
- Comply with OSHA standard. Equipped with adjustable legs and Grounding wires.
- Dual Ventilation holes with flame arrestors.

Widely used in chemical industry, public security, safety supervision and other related industries and laboratory applications.



MODLE		ASYC0012W	ASYC0022W	ASYC0030W	ASSYC0045W	ASYC0060W	ASYC0090W
H × W × D	mm	890x590x460	1650x590x460	1120x1090x460	1650x1090x460	1650x860x860	1650x1090x860
Capacity	Gal/Ltr	12/45	22/83	30/114	45/170	60/227	90/340
Shelves	pcs	1	2	1	2	2	2
Loading capacity	kg	50	50	100	100	100	100
Door type		single door	single door	double door	double door	double door	double door
Art.No.		201380	201381	201382	201383	210384	201385
Accessory							
Art.No.	shelves	212001	212002	212003	212004	212005	212006
Art.No.	PP shelves	212021	212022	212023	212024	212025	212026

# EXPLOSION PROOF GAS CYLINDER CABINET



- Cabinet body was applied 1.2mm thickness high quality cold rolled steel plates, surface is coated by electrostatic spraying of epoxy powder .
- PASS hole on the both side of body.
- Apply explosion proof gas detector to distinguish most flammable gas, it has explosion proof certificate.
- Apply explosion-proof audible and visual alarm device, when detect the gas leakage, it will automatically alert .
- Apply automatic interlocking strong exhaust system in the gas cylinder storage cabinet , and by exhaust pipe to exhaust outside
- Toxic gas is connected to adsorption treatment device through exhaust pipe .
- Cabinets with fixed belt to keep the gas cylinder stabile.

**NEW**



Cylinder number		single cylinder	double cylinder	three cylinder
HxWxD	mm	1990x600x450	1990x900x450	1990x1200x450
Model		ASY-FBEX-1	ASY-FBEX-2	ASY-FBEX-3



## GAS CYLINDER STORAGE CABINET

Gas cylinder storage cabinets are main products for storage of gas cylinders in laboratory. Its function is for protecting the inside gas cylinder from the outside fire, and the surroundings from the internal fire if any. The entire body of cabinet is made of high quality CRS plates, nice seamless body, good load capacity, easy to assemble and repair, and convenient to transport.

- Body: Apply high quality cold rolled steel plates, treated with acid pickling and phosphating passivation, surface is coated by electrostatic spraying of epoxy powder to resist the acid, alkali and rusty.
- Door: removable linkage, with perspective window in the door.
- PASS hole: PASS hole on the both side of body, to ensure the fresh air flow inside.

- Fixed belt: With fixed belt to keep the gas cylinder stable.
- Fold down ramp: Adjustable fold down ramp on the bottom, easy to load or unload the gas cylinder bottle in and out. (optional)
- Handle: flush-mounted high-strength handle.
- Alarm: Alarm device can identify: combustible gas (such as methane, acetylene, gas, hydrogen, etc.), using special combustible gas detectors, air diffusion sampling, when the cut-off point to a concentration of chip set, will automatically alert.
- Automatic exhaust system: Once the sensor detects the gas leakage and alerts, the exhaust fan on the top of cabinet will automatically work, and pump the gas outside the cabinet through the pipe, to ensure the safety of workers in work area.
- Special purpose alarm device is available according to the storage requirement, more safety and reliability.

Nos. of gas cylinder	1	2	3	4
All steel gas cylinder cabinet				
MODLE	ASY-QPG-1	ASY-QPG-2	ASY-QPG-3	ASY-QPG-4
HxWxD	1800x600x450	1800x900x450	1800x1200x450	1800x1500x450
Art.No.	201500	201501	201502	201503
Explosion proof gas cylinder cabinet				
MODLE	ASY-FBQPG-1	ASY-FBQPG-2	ASY-FBQPG-3	ASY-FBQPG-4
HxWxD	1900x600x450	1900x900x450	1900x1200x450	1900x1500x450
Art.No.	201520	201521	201522	201523

\* The cabinet is without gas detector and alarm, need additional selecting.

Gas Detector Alarm:

Gas test	General flammable gas	O <sub>2</sub>	H <sub>2</sub>	N <sub>2</sub>	CH <sub>4</sub>	C <sub>2</sub> H <sub>2</sub>	CO
Art.No.	211500	211501	211502	211503	211504	211505	211506

Gas test	NH <sub>3</sub>	AR	CL <sub>2</sub>	He	N <sub>2</sub> O	SO <sub>2</sub>	H <sub>2</sub> S
Art.No.	211507	211508	211509	211510	211513	211517	211518





## GAS CYLINDER STORAGE CAGE

Applicated in storage of liquefied gas cylinders and compressed gas cylinders.

- The side of the cabinet, the back and the door made by the metal mesh, keep the internal ventilation and objects visibility.
- The vertical cylinder is equipped with a length adjustable chain that keeps the tank in suitable place.
- There are flammable warning signs on the door, heavy hinges prevent the door sagging, have hanging lock buckle (without padlock), the magnet makes the door closed when unlocked.
- Compliant with OSHA and NFPA standards
- Durable safe yellow epoxy electrostatic spray, finished product shipments
- Widely used in factories, laboratories and warehouses and other places of liquefied gas cylinders and compressed cylinders Reasonable, standardized, durable, secure storage.

Accessory: Explosion lock  
Artical No.: 212040



MODEL		①	②	③	④	⑤	⑥
H x W x D	m m	889x787x762	1651x787x762	1651x787x762	1651x1524x762	1651x1524x762	1651x1524x762
Number of cylinders stored horizontally	pc	4	8	-	16	-	8
Number of cylinders stored vertically	pc	-	-	9	-	18	9
Adjustable chain number		-	-	2	-	2	2
Artical No.		201530	201531	201532	201533	201534	201535

## (LPG)GAS CYLINDER STORAGE CAGES

Available in a range of sizes. They ensure the safe storage of Class 2.1 Flammable Gases. Built from sheet steel with fully welded seams, the frame is complete with a powder coat finish for quality and durability. Extra security features are also included like bolt-down plates, restraints and lockable doors.

- Complies with relevant Australian Standards.
- Specifically designed for storage of LPG cylinders.
- Heavy duty design with forklift channel and restraining chains.
- Pad-lockable door for increased security.
- Natural ventilation
- Appropriate warning and safety signage that complies with Australian Standards.

Gas cylinders are used across a wide range of industries, including science and education, medical, manufacturing, civil construction, engineering, and hospital.



T size LPG cylinders	2	4	6	12	
External Dimensions H x W x D	mm	1023x750x450	1050x750x750	1050x1100x750	2000x1100x750
Internal Dimensions H x W x D	mm	915x690x428	975x690x690	975x1020x670	1925x1020x670
Weight	kg	35	65	95	182
Art.No.		202301	202302	202303	202304

## 9 KG LPG CYLINDER STORAGE

LPG Gas Cylinder Storage Cages are perfect for storing LPG cylinders vertically and specifically designed with compact modules to suit small 9kg LPG and general purpose cylinders. Heavy duty design and durable green powder coat, the LPG storage cages come with a pad-lockable door and bolt down feet for increased security.

- Compact storage cabinets specifically suited to small 9 kg LPG cylinders and general purpose cylinders
- Heavy-duty perforated steel construction
- Restraining chain and bolt-down provision to keep cylinders in place
- Pad-lockable door for increased security
- Natural ventilation that complies



9kg LPG cylinders	2	4	6	8	
External Dimensions H x W x D	mm	620x720x400	1190x720x400	1190x1030x400	1190x720x720
Internal Dimensions H x W x D	mm	560x660x380	1120x660x380	1120x970x380	1120x660x700
Weight	kg	19.5	38	54	68
Art.No.		202305	202306	202307	202308

# PP ACID & CORROSIVE STORAGE CABINET



Used for standard manage corrosive chemicals and classified storage

- Cabinet used PP boards (polypropylene) with seamless welding engineering, equipped with leakage-proof adjustable shelves, which could be detached out and easy to be cleaned. Adjustable pp shelves can be adjusted height by requirements.
- To improve operational safety, padlock could be used to provide extra protection.
- Used to store strong corrosive chemicals, such as sulfuric acid and nitric acid etc. to protect cabinet operator and people around.
- Widely used in pharmaceutical, chemical, laboratory and other fields.

## Polypropylene storage cabinet - professional design for storage strong corrosive chemicals

Special specifications of white PP polypropylene anti-corrosive chemical safety storage cabinets can also be customized for customers to store all kinds of strong acid and alkali chemicals.

Three strong acids are sulfuric acid, hydrochloric acid and nitric acid .  
 Three strong alkalis are sodium hydroxide, potassium hydroxide and barium hydroxide.



padlock

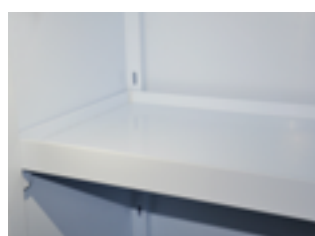

shelf



hinge

MODLE	ASYP0004	ASYP0012	ASYP0026	ASYP0030	ASYP0045	ASYP0060	ASYP0090
H × W × D mm	560x430x430	890x590x460	900x910x600	1120x1090x460	1650x1090x460	1650x860x860	1650x1090x860
Capacity Gal/Ltr	4/15	12/45	26/100	30/114	45/170	60/227	90/340
Shelves pcs	1	1	1	2	2	2	2
Loading capacity kg	25	30	35	40	40	40	40
Door type	single-door	single-door	double-door	double-door	double-door	double-door	double-door
Art.No.	201400	201401	201402	201403	201404	201405	201406
Art.No. PP shelves	211400	211401	211402	211403	211404	211405	211406

## PP MEDICINES CABINET / REAGENT CABINET



Used for effectively classify and store medicines and reagents.

PP boards (polypropylene) are used to form the cabinet by seamless welding engineering with high strong acid, alkali and corrosion resistance capacity

Door's hinge is made of injection molding of PP material with corrosive resistance.



The windows of PP medicines cabinet is made of organic glass

Adjustable pp shelves can be adjusted height by requirements, its edge have spill-proof effect



ASPM1800-1



ASYPM1800-2



ASYPM1800-3



ASYPM1800-4



ASYPM1800-5

MODEL		ASYPM1800-1	ASYPM1800-2	ASYPM1800-3	ASYPM1800-4	ASYPM1800-5
H×W×D	mm	1800x900x450	1800x900x450	1800x900x450	1800x900x450	1800x900x450
Shelves	pcs	2	2	2	2	2
Loading capacity	kg	50	50	50	50	50
window		no	yes	no	yes	yes
Door type		double door	double door	four door	four door	four door
Art.No.		201420	201421	201422	201423	201424



## PP FUME HOOD



Excellent acid resistance and can be used in high-intensity acid-base laboratory.

- Made of PP (polypropylene) sheet seamless welding, with strong acid, alkali and corrosion resistance characteristics.
  - Air collecting hood: PP plate forming conical shrinkable air collecting hood, air collecting hood has good conical air collecting angle and smoothness, average exhaust.
  - The fume hood conforms to the technical standard of the China machinery industry standard "exhaust Cabinet" JB/6412-1999.
  - In the temperature range of -8℃ to +80℃, it has the characteristics of corrosion resistance and strong acid resistance.
- It is used in high-strength acid-base laboratory, purification room and other places.

Guide plate:  
8mm thick PP profile, divided into upper, middle and lower three layers, can effectively discharge different weights of gas

Power socket

Operator table



The control panel is designed on the outer panel for easy operation, observation and control

Safety tempered glass door: made of tempered glass, single-side up and down operation with balancing device, operation smoothly & quietly

MODEL		ASYTP1200	ASYTP1500	ASYTP1800
H×W×D	mm	2350x1200x850	2350x1500x850	2350x1800x850
Table top		PP(Polypropylene) plate or physicochemical board, epoxy board, ceramic board.		
Sash		transparent tempered glass, thickness is 5MM		
Light device		Fluorescent lamp		
Electric power socket		AC220V/10A or customized		
Optional accessories		Sink, air plunger, water plunger, ventilation fan, socket, anti-explosion lighting, Air valve control		

## COUNTERTOP PE SPILL CONTAINMENT TRAY

- Compact size fits on tabletop or countertop
- Inside can hold 5.6L leakage
- Translucent sidewalls let you easily inspect fluid level in sump
- Pour spout for easy draining

Style	Grate Included
Color	White/Black
Dimension	430mm*305mm*100mm(L*W*H)
Loading Capacity	41kg
Sump Capacity	5.6L
Weight	2.27kg
Material	Polyethylene(PE)





## STEEL FUME HOOD

Metal Fume Hoods protect laboratory staff from noxious fumes when working with acids, dangerous gas, organic solvents, etc. Harmful and unpleasant chemical fumes are removed from the controlled environment to facilitate a safe and pleasant work environment.

The fume hood channels chemical vapors out of the building using an external fan installed on the roof or on an external wall. The hood structure is made of 7 mm epoxy-covered metal, while the internal structure is made of steel plate 4 mm.

- Metal epoxy-coated oven-tempered structure
- Tempered glass sliding front sash
- Air suction from both the top and back panel
- LED lighting at 800 LUX, with optional rupture protection
- Airflow velocity of  $0.5 \pm 0.1$  m/s,  $100 \pm 20$  FPM
- High durability and easy cleaning, option for polypropylene / stainless steel
- Easy access for maintenance at side
- Control panel including on/off unit power and light switch
- Includes metal lower base cabinet



Model No.	ASYTS1200	ASYTS1500	ASYTS1800
H×W×D mm	2350x1200x850	2350x1500x850	2350x1800x850



## PE IBC SPILL PALLET

- Made of stronger modified plastics.
- Integral supporting upstands with grid and drain .
- Suitable for storage most 1000 litres IBC footprint or 1200 x 1100mm pallet of drums or containers.
- Dual ends forklift pockets are compatible with most forklifts and pallet trucks.
- Easy to move when not loaded (this is the safest mode of transport).
- Nestable design to minimal the space for storage and shipment.
- Highly visible and resistant to wide range of industrial liquids.
- Rugged construction takes industry leading load capacities.
- Individual units are nestable for efficient storage and transport.



MATERIAL		Polyethylene
Color		Yellow
Dimensions	L*W*H	mm
		1380*1380*900
Spill containment volume		L
		343/1300
Static load		kg
		3000
Dynamic load		kg
		1500
Model		ASYPE-IBC

### MEETS REGULATION:

EPA 40CFR 264.175, SPCC 40CFR112.7, NPDES 40 CFR 122.20



## POLYETHYLENE SPILL CONTAINMENT PALLET

Valid for pallet jack

- Used for spill control, this PE polyethylene spill pallet is used for the transportation of multiple kinds of chemical products, and also operations like oil extraction, filling and packing are valid to be carried out on it.

- The orange peel surface makes sure the grid won't break under full loaded, the grid is able to be taken off; draining outlet is set for fast speed liquid treatment.

- The spill containment decks and pallets are able to be transferred by pallet jacks, and they are able to carry oil drums of 200L, chemical drums, all kinds of containers and small mechanisms.

- The material of polyethylene is able to against most chemical, the pallet structure is solid and stackable, stacking pallets can save space and shipping cost.

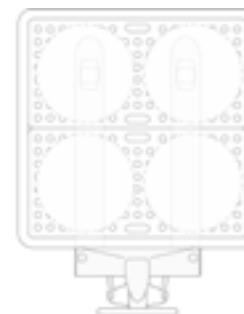
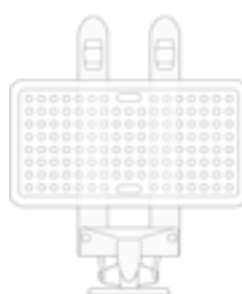

MODEL		Spill Deck		Spill Pallet	
		1300×690×150	1300×1300×150	1300×690×300	1300×1300×300
L×W×H	mm	1300×690×150	1300×1300×150	1300×690×300	1300×1300×300
Valid for drums of 200L		2	4	2	4
Spill containment volume	L	65	120	120	250
Static load	kg	1200	2600	1200	2600
Dynamic load	kg	600	1200	600	1200
Cargo No.		① 202051	② 202052	③ 202053	④ 202054



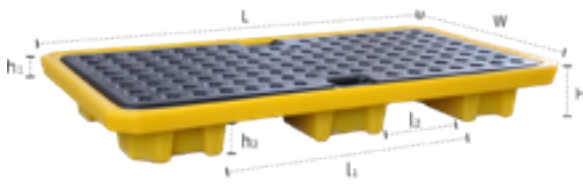

①

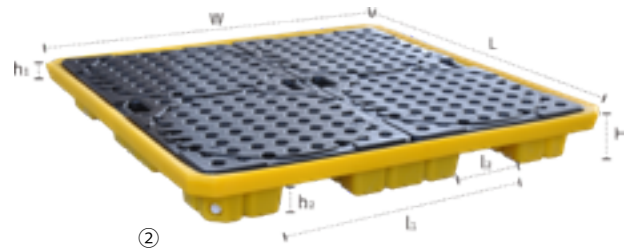

②

Polyethylene spill containment deck(for two drums) mm						
L	W	H	l1	l2	h1	h2
1300	690	150	685	250	45	100
Valid for double direction operation of fork lifter and model 550/685 pallet jacks						

Polyethylene spill containment deck(for four drums) mm						
L	W	H	l1	l2	h1	h2
1300	1300	150	835	255	45	100
Valid for double direction operation of fork lifter and model 685 pallet jacks						

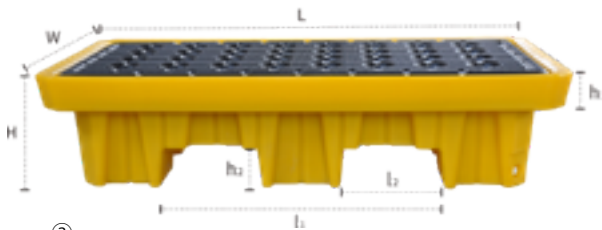

③

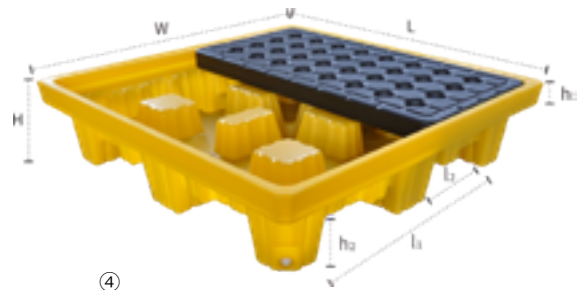

④

Polyethylene spill containment pallet(for two drums) mm						
L	W	H	l1	l2	h1	h2
1300	690	300	725	260	55	100
Valid for double direction operation of fork lifter and model 550/685 pallet jacks						

Polyethylene spill containment pallet(for four drums) mm						
L	W	H	l1	l2	h1	h2
1300	1300	300	845	350	55	100
Valid for double direction operation of fork lifter and model 550/685 pallet jacks						



Model 550 pallet jack

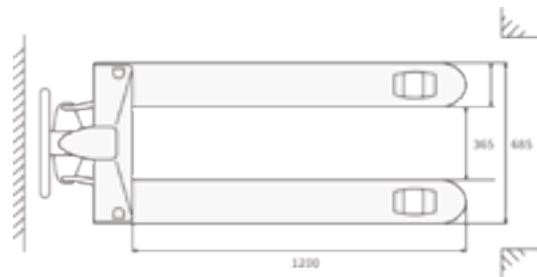

Model 685 pallet jack

## STEEL SPILL CONTAINMENT PALLET

### For 200 litre drums and small containers

- Double layers, robust construction
- Tapered structure, stacked on each other (No Grille) for Space saving
- Sump clearance height 100mm, easy for hoisting and transportation
- For 60 /200 litre drums or small containers, in compliance with relevant regulations
- 3mm Sheet steel, surface powder coated or hot dip galvanized



L×W×H	mm	800×800×365		1200×800×360		1800×800×275		1200×1200×285		2400×800×250		2700×1300×205	
Grille		no	yes	no	yes	no	yes	no	yes	no	yes	yes	
200L drum		-	1	-	2	-	3	-	4	-	4	8	
Spill capacity	L	210	203	224	215	217	202	230	216	241	222	194	
Art.No.	red	201071	201077	201083	201089	201095	201101	201107	201113	201119	201125	201131	
	yellow	201072	201078	201084	201090	201096	201102	201108	201114	201120	201126	201132	
	blue	201073	201079	201085	201091	201097	201103	201109	201115	201121	201127	201133	
	Hot-Dip Galvanized	201076	201082	201088	201094	201100	201106	201112	201118	201124	201130	201134	

## MOBILE SUMP TRAY

### For 60/200 Litre Drums

Safe and economical efficiency filling and storage in transportation

- Constructed with sheet steel, painted or hot dip galvanized
- Mobile zinc plated grate, Max. load 1000 kg/m<sup>2</sup>.
- Zinc coated drum stand is optional, for horizontal storage and filling
- Fastener tape is optional
- Sump tray is constructed with 3mm Sheet steel, surface painted or hot dip galvanized with handle.



L×W	mm	①	②		③	④		⑤	⑥	⑦
Drum	Nos. × Litre	1×200L	2×60L	2×200L	3×200L	1×60L	1×200L	1×200	2×200	1×200
Placement		vertical	vertical	vertical	vertical	horizontal	horizontal	vertical	vertical	horizontal
Spill capacity	L	203	61	215	202	61	215	215	225	225
L×W	mm	800×800	800×500	1200×800	1800×800	800×500	1200×800	800×800	1200×800	1200×800
Height N/Y handle	mm	615/1115	415/1080	510/1115	530/1115	415/1080	510/1115	700/1115	570/1115	570/1115
Art.No.	red	201155	201160	201165	201170	201175	201180	201185	201190	201195
	yellow	201156	201161	201166	201171	201176	201181	201186	201191	201196
	blue	201157	201162	201167	201172	201177	201182	201187	201192	201197
	Hot-Dip Galvanized	201159	201164	201169	201174	201179	201184	201189	201194	201199

# STEEL SPILL CONTAINMENT PALLET FOR IBC TANK

For the regulation compliant storage and filling of water hazardous and flammable liquids in IBC containers and drums.

- For flammable liquids in GHS categories 1 – 3 as well as water hazardous liquids in GHS categories 1 – 4
- Sump tray made of 3mm Sheet steel
- With Zinc plated support grates for storing drums and IBC Containers
- Grille and brackets can be used in combination. Brackets position could be confirmed on required
- Fork guides provide 100mm clearance height for easy handling with lifting devices

## ACCESSORIES

**3-sided Splash protection wall, additional protection when filling.**



MODEL		①	②	③	④	⑤	⑥
Capacity	1000L tank 200Ldrum	1 4	1 -	2 8	2 10	2 -	2 4
Bracket	pcs	-	1	-	-	2	1
L×W ×H	mm	1460×1460×620	1460×1460×1083	2650×1300×435	2690×1650×375	2650×1460×863	2650×1460×863
Loading capacity	kg	1900	1900	3800	3800	3800	3800
Art.No.	red	201200	201205	201210	201215	201225	201230
	yellow	201201	201206	201211	201216	201226	201231
	blue	201202	201207	201212	201217	201227	201232
	Hot-Dip Galvanized	201204	201209	201214	201219	201229	201234

Accessory					
L × W × H	mm	1460×1460×1000	2650×1300×1000	2690×1650×1000	2650×1460×1000
Art.No.	3-sided splash protection wall	211040	211041	211042	211043

## OILY WASTE CAN



- Handle design, easy to carry and emptying.
- Self-closing lid design to keep it closed when not in use so as to isolate wastes from fire source and limit the amount of oxygen, therefore to eliminate effectively the risks of spontaneous combustion.
- High-quality galvanized steel structure (0.8mm thick) with epoxy resin coating on both inside and outside walls to make the product more durable and chemical resistant.
- The cylindrical structure and heightening type bottom can promote the flow of air around the bucket.
- Pedal design to liberate hands in operation.
- Different sizes of oil waste can meet the use of different environmental requirements. It is very convenient to make choice.

OSHA compliant Oily waste can is specially used for collecting oil-soaked (e.g. combustible solvent, Linseed oil, other flammable liquids) rags and cloths to effectively prevent the fire risks.

Capacity: 35L  
 Model No.: ASYOW (red/yellow)  
 Parameter: W440\*D425\*H490mm



## BIOCHEMICAL TRASH CAN

- Polyethylene HDPE molding, durable and corrosion resistant. There are two choices of red and yellow colors, with labeling of biochemical hazard.
- The bucket can store rags or wipes impregnated with solvents, substitutes, linseed oil, flammable adhesives and other flammable liquids.
- Cover opening of foot control, which is able to close automatically. When it is closed, the contents inside are isolated from the fire source, limited amount of oxygen would prevent the combustion from continuing, and eliminating hidden dangers.

This product is suitable for most hazardous chemicals such as solid waste, solvents, waste wipes, debris and other materials in a short-term manner, in order to prevent spontaneous combustion, and can be used independently or with a chemical-resistant treatment bag.

Capacity: 22.5L/6 gallon  
 Model No.: ASYPW2006 (red/yellow)  
 Parameter: W419\*D343\*H406mm



## PORTABLE EYEWASH



This product can be used in field of Petroleum, Chemical, Laboratory, Medical Treatment etc., and flushing the chemistry liquid sputtered eye and face rapidly, reduce the level of injury to the minimum.

Pull down eye wash arm placidly, so open to spray.

When wash eyes, open eyes wholly, sufficient wash, the wash time is not less than 15 minutes.

After wash, need medical treatment forward.

- Material: Polyester, pro-environment and safety.
- Water injection hole: Wide water injection hole and apt to inject water, have dust cover.
- Water flow: Due to change diameter on the water hole, so more bonhomie and enrich, water yield is not lower than 1.5L/minute.



16 Gallon capacity

ASH7501



8 Gallon capacity

ASH7500

## EMERGENCY SHOWER AND EYE WASH STATION

This product is safety device for emergency treatment in hazardous work areas and laboratories in pharmaceutical, chemical, petrochemical, electronics, and semiconductor companies.

- The main material is stainless steel, with high-brightness epoxy resin surface coating, which is anti-corrosion, anti-ultraviolet radiation and anti-leak.
- The spray and eye wash is controlled through ball valve and spiral sealing structure, which is convenient for operation, fast open and close and reliable sealing.



with flip cover and foot pedal



ABS coated stainless steel

MODEL	ASYES01-S	ASYES02-S	ASYES03-A	ASYES04-A	ASYES08-S	ASYES-ME01
Outer dimension height mm	2480	2480	2480	2480	2480	2480
Piping 5/4 inches	Stainless steel 304	Stainless steel 304	Stainless steel 304 ABS coated	Stainless steel 304 ABS coated	Stainless steel 304	Stainless steel 304
Water inlet height mm	1580	1580	1580	1580	1580	1580
Waste water outlet height mm	150	150	150	150	150	150
Foot pedal	without	with	without	with	with	without
Shower water flow min	120-180L	120-180L	120-180L	120-180L	120-180L	120-180L
Eye wash water flow min	12-18L	12-18L	12-18L	12-18L	12-18L	12-18L
Water pressure Mpa	0.25-0.4	0.25-0.4	0.25-0.4	0.25-0.4	0.25-0.4	0.25-0.4



## SPILL PROTECTION EMERGENCY ADSORBENT KIT

Suitable for cleaning, containment and prevention of any possible oil and chemical leakage areas, including manufacturing industries, transportation, petrochemical industry, marine emergency rescue, ports, aviation, public security and fire protection, medical industry, energy and power industry, environmental protection, army, food processing and any places needing removal of liquid leakage.



**White color**  
Absorbs oil and oil-based liquids, does not absorb water



**Yellow color**  
Absorbs strong acid and bases, solidified liquids and unknown liquids

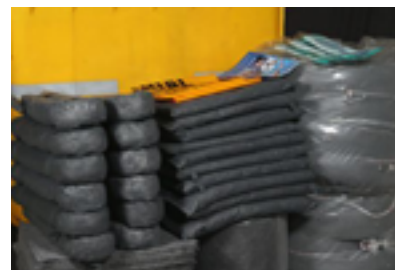

**Grey color**  
Absorbs oil, coolant, water and other liquids

Absorb volume of all accessories	30L		45L		120L		240L	
	Absorbent mat	20pcs	Absorbent mat	30pcs	Absorbent mat	50pcs	Absorbent mat	100pcs
Absorbent sock	2pcs	Absorbent sock	3pcs	Absorbent sock	10pcs	Absorbent sock	16pcs	
Absorbent pillow	2pcs	Absorbent pillow	4pcs	Absorbent pillow	10pcs	Absorbent pillow	8pcs	
Rubber glove	1pairs	Rubber glove	1pairs	Rubber glove	2pairs	Rubber glove	2pairs	
Recycle bag & bands	2sets	Recycle bag & bands	3sets	Recycle bag & bands	8sets	Recycle bag & bands	10sets	
Goggle	1pairs	Goggle	1pairs	Goggle	2pairs	Goggle	2pairs	
Kit bag	1pcs	Kit bag	1pcs	120L round barrel Movable barrel with wheels	1pcs	240L round barrel Movable barrel with wheels	1pcs	
Model number	ASYSK30 series		ASYSK45 series		ASYSK120 series		ASYSK240 series	

## EASY-TEAR ROLL OF OIL ABSORBENT PAD

For large areas of ground or water surface, areas with oil pollution and chemical leakage such as work shops and machinery ragging.

Oil pad with easy-tear press point/composite press point, the surface has ultrasonic press point or composite press point, which is more wear-resistant and durable. With easy-tear lines for easy selection of suitable size.

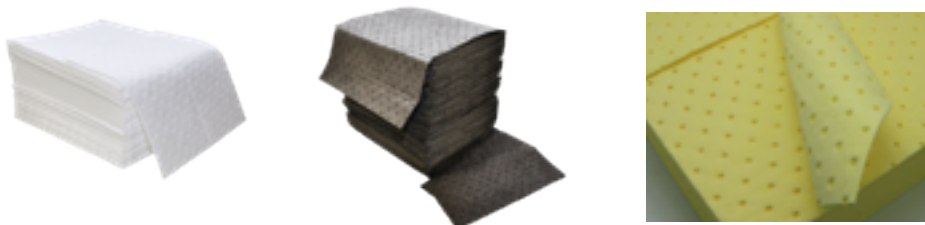

	White color Oil absorbent	Yellow color Chemical absorbent	Grey color Universal absorbent	High durability	High absorption
Size	mm	400×500	400×500	400×500	400×500
Thickness	mm	2	3	4	5
Packing quantity	PCS/B	100	100	100	100
Absorption	L/B	≥120	≥126	≥135	≥144
Model number		ASYA210-3 series	ASYA310-3 series	ASYA410-3 series	ASYA510-3 series

Accidents can happen, when an emergency occurs, the spill-absorbent kit would be your best choice. It is easy to use and always ready for your needs. Various accessories in the kit can be added or removed according to your needs.

## ABSORBENT SOCK

Used to contain spilled oil and chemical leakage like oil tankers, mailboxes, oil pipelines, workshop machinery, water surface, etc.

It is soft and flexible to placed in the required place to prevent oil from leaking and spreading. Petroleum products are able to be absorbed and aquatic products are not.



White color Oil absorbent	Yellow color Chemical absorbent	Grey color Universal absorbent
------------------------------	------------------------------------	-----------------------------------

High durability High absorption

Size	mm	Φ 76×1200	Φ 100×3000	Φ 127×3000	Φ 200×3000
Packing quantity	PCS/B	20	4	4	4
Absorption	L/B	≥126	≥108	≥130	≥288
Model number		ASYAS01 Series	ASYAS02 Series	ASYAS03 Series	ASYAS05 Series

## ABSORBENT PILLOW

It is used for oily and chemically leaking floors, faucets, valves, machinery, under pipes and uneven areas.

Small sized with large absorption, can be used with plastic trays.

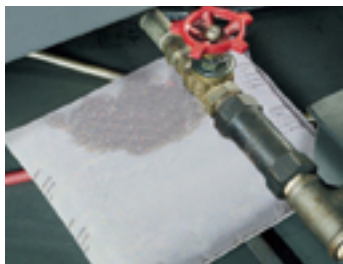

White color Oil absorbent	Yellow color Chemical absorbent	Grey color Universal absorbent
------------------------------	------------------------------------	-----------------------------------

High durability High absorption

Size	mm	400×500	400×500	400×500
Packing quantity	PCS/B	16	16	16
Absorption	L/B	≥144	≥144	≥144
Model number		ASYOP16-O series	ASYOP16-C series	ASYOP16-G series

# Global expert on safe storage system

## Strict compliance with international standards

### Aenon Safety LLC

Address: 5245 Vista Blvd. Suite F3-180, Sparks, Nevada 89436

Telephone: +1 775-473-9750

Fax: +1 775-473-9752

Postal code: 89436

Website: [www.aenonsafety.com](http://www.aenonsafety.com)

Email: [info@aenonsafety.com](mailto:info@aenonsafety.com)